

DISTRICT OF COLUMBIA GOVERNMENT  
OFFICE OF THE SURVEYOR

Washington, D.C., March 22, 2010

Plat for Building Permit of: SQUARE 1173 LOT 820

Scale: 1 inch = 50 feet Recorded in Book A & T Page 3721 - F

Receipt No. 07146

Furnished to: FRANK MOODY

I hereby certify that all existing improvements shown hereon, are completely dimensioned, and are correctly platted; that all proposed buildings or construction, or parts thereof, including covered porches, are correctly dimensioned and platted and agree with plans accompanying the application; that the foundation plans as shown hereon is drawn, and dimensioned accurately to the same scale as the property lines shown on this plat; and that by reason of the proposed improvements to be erected as shown hereon the size of any adjoining lot or premises is not decreased to an area less than is required by the Zoning Regulations for light and ventilation; and it is further certified and agreed that accessible parking area where required by the Zoning Regulations will be reserved in accordance with the Zoning Regulations, and that this area has been correctly drawn and dimensioned hereon. It is further agreed that the elevation of the accessible parking area with respect to the Highway Department approved curb and alley grade will not result in a rate of grade along centerline of driveway at any point on private property in excess of 20% for single-family dwellings or flats, or in excess of 12% at any point for other buildings. (The policy of the Highway Department permits a maximum driveway grade of 12% across the public parking and the private restricted property.)

Date: \_\_\_\_\_

\_\_\_\_\_  
Surveyor, D.C.  
By: A.S.

\_\_\_\_\_  
(Signature of owner or his authorized agent)

NOTE: Data shown for Assessment and Taxation Lots or Parcels are in accordance with the records of the Department of Finance and Revenue, Assessment Administration, and do not necessarily agree with deed description.

**OFFICIAL**  
**GOVERNMENT OF THE DISTRICT OF COLUMBIA**  
**LICENSING & PERMITTING**  
All work must be done strictly in accordance herewith and approved plans must be kept on the site until completion of construction. No inspection will be made unless Approved Plans are on job site.

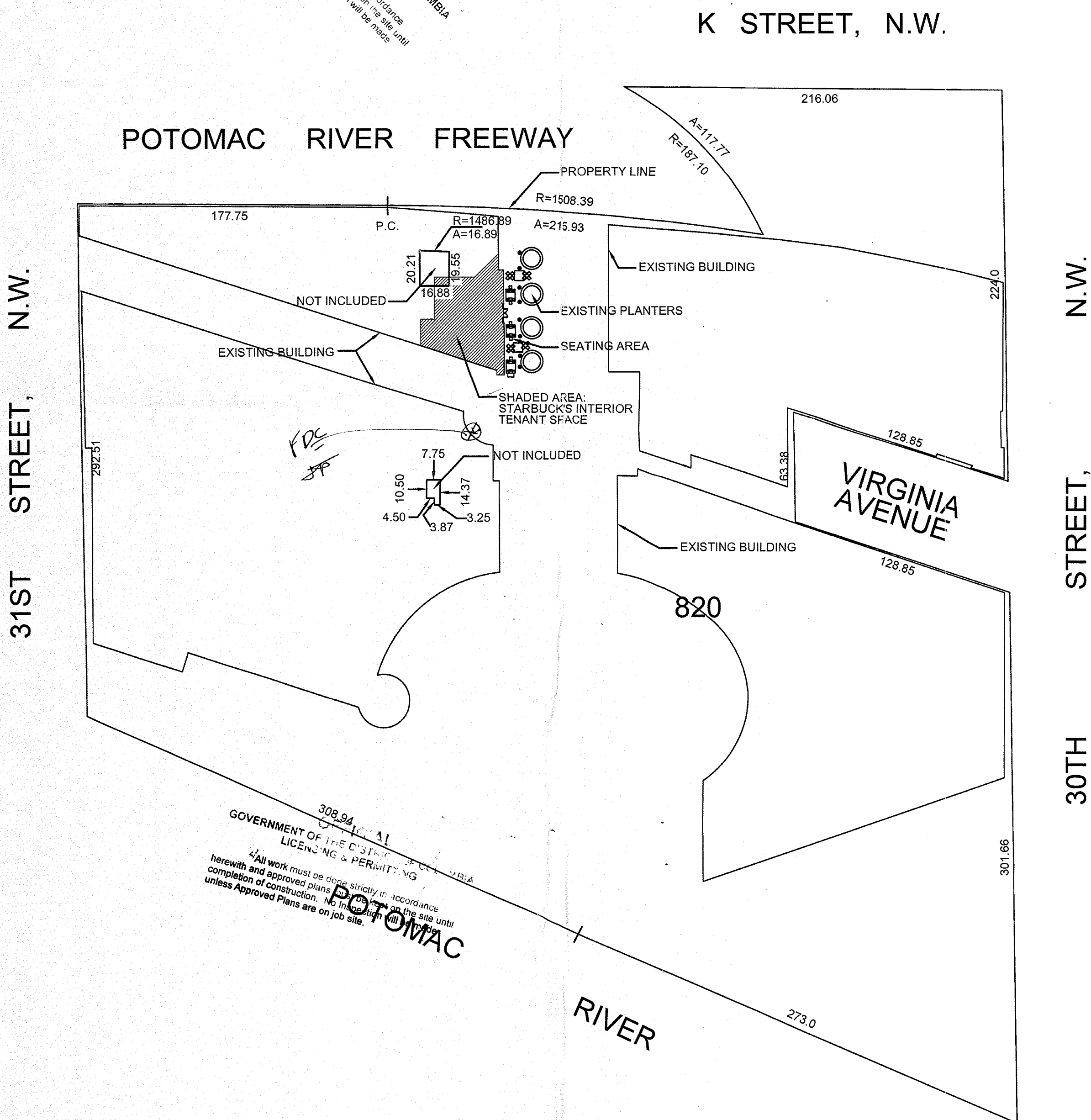

**OFFICIAL**  
**GOVERNMENT OF THE DISTRICT OF COLUMBIA**  
**LICENSING & PERMITTING**  
All work must be done strictly in accordance herewith and approved plans must be kept on the site until completion of construction. No inspection will be made unless Approved Plans are on job site.

All work must be done strictly in accordance herewith and approved plans must be kept on the site until completion of construction. No inspection will be made unless Approved Plans are on job site.