

**FURNITURE SCHEDULE:**

ITEM#	QTY	DESCRIPTION	MANUFACTURER	MODEL	SKU	SHIP
<b>TABLES</b>						
F764	7	TABLE, PATIO ROUND WOOD TOP	SMITH AND HAWKEN	896696	223219	3PL
F765	1	TABLE, PATIO ADA WOOD TOP	SMITH AND HAWKEN	896704	223240	3PL
<b>CHAIRS</b>						
F784	24	CHAIR, PATIO TEAK	SMITH AND HAWKEN	896662	223231	3PL
F776	2	BASE UMBRELLA 6' 95 LBS	ULTIMATE UMBRELLA CO	SBUXACF95W	223127	3PL
F891	2	UMBRELLA 6' OUTDOOR BLANK	ULTIMATE UMBRELLA CO		393998	3PL

**SIDE WALK CAFE NOTES:**

SURFACE SPACE = 289 S.F.

TOTAL SQ. FOOTAGE = 449 S.F.

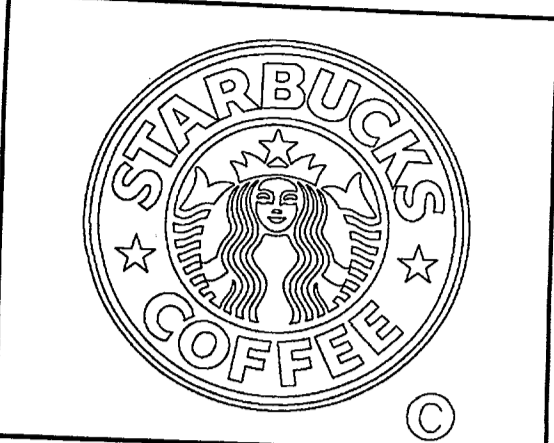

**STARBUCKS COFFEE COMPANY**  
 2401 UTAH AVENUE SOUTH  
 SEATTLE, WASHINGTON 98134  
 (206) 318-1575

THESE PLANS AND SPECIFICATIONS, AS WELL AS STARBUCKS NAME AND LOGO, TRADEMARKS AND DESIGNS ARE THE EXCLUSIVE PROPERTY OF STARBUCKS CORPORATION. ANY REPRODUCTION, MODIFICATION, DISCLOSURE AND/OR USE OF THESE MATERIALS FOR ANY PORTION OF THEM WITHOUT STARBUCKS' PRIOR WRITTEN CONSENT IS STRICTLY PROHIBITED.

**ARCHITECT OF RECORD**  
**AHA**  
 ALAN HAMM ARCHITECTS  
 10001 METROPOLITAN AVENUE • KENNESAW, WA 98148  
 TEL: 360-469-0230 • FAX: 360-469-0234 • WWW.ALANHAMM.COM

**REV DATE JC DESCRIPTION**

**STARBUCKS COFFEE**  
**NAVY YARD**  
 1200 NEW JERSEY AVE SE  
 WASHINGTON, DC 20374  
 JURISDICTION: WASHINGTON, DC

**STORE #:**  
**PROJECT #:** 32963-001  
**CONCEPT:** MSS-MED-ENG2-RH  
**PALETTE:** DI MODA  
**ISSUE DATE:** 12/7/07  
**PM:** G. PHILIPPON  
**JC:** F. BARNES  
**CHECKED:** J. STEFFEN  
**CM:** ANDREW RICHARDSON

**SHEET TITLE**  
**COMPOSITE PLAN**  
 SCALE: 1/4"=1'-0"  
 (DO NOT SCALE DRAWINGS)

**SHEET NUMBER**  
**A8.3**

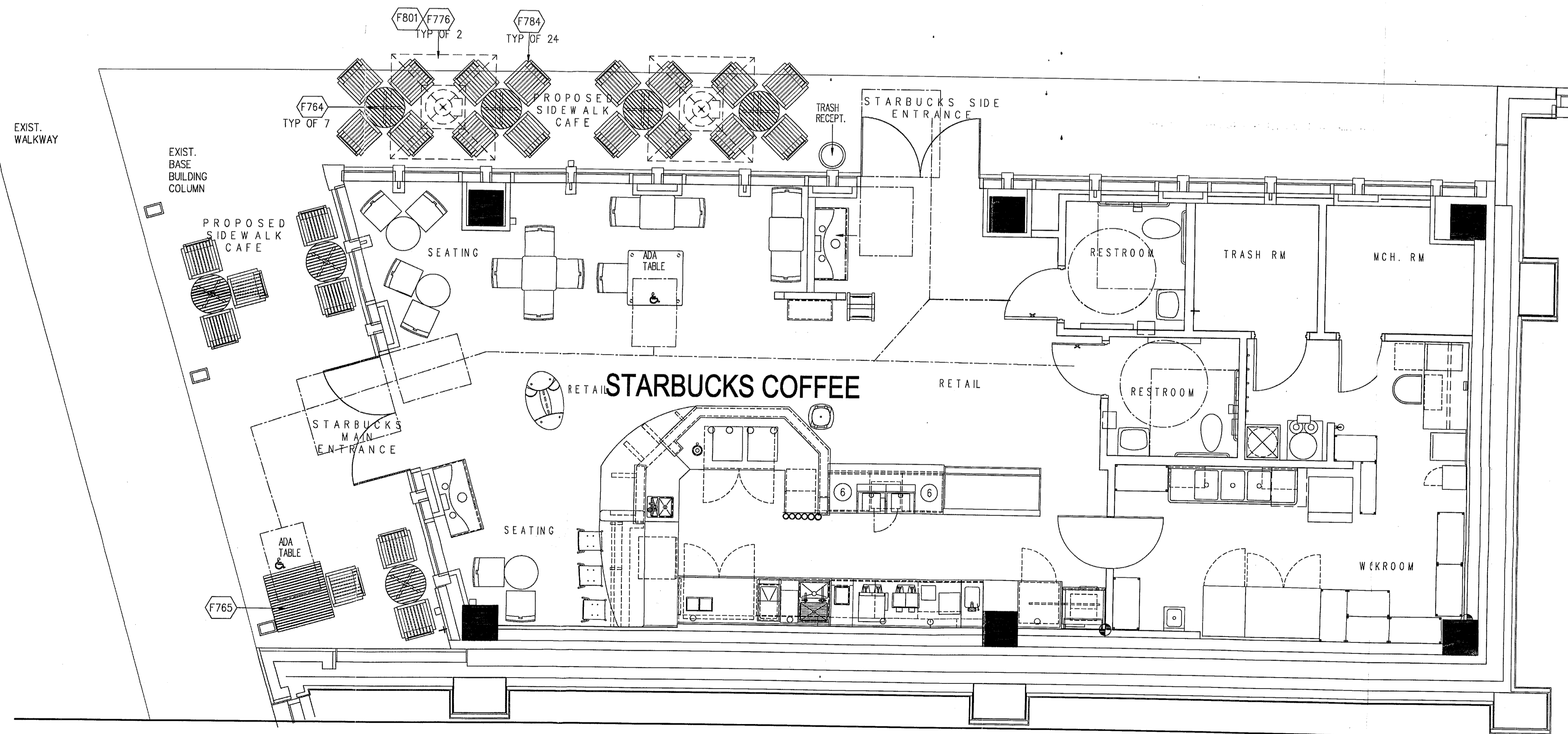

**OFFICIAL**  
 GOVERNMENT OF THE DISTRICT OF COLUMBIA  
 LICENSING & PERMITTING

All work must be done strictly in accordance herewith and approved plans must be kept on the site until completion of construction. No inspection will be made unless reports on Plans are on job site.

**COMPOSITE PLAN**

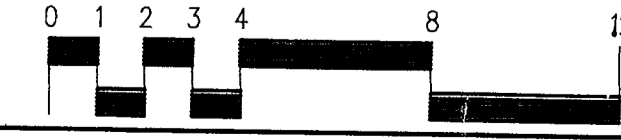

**GOVERNMENT OF THE DISTRICT OF COLUMBIA LICENSING & PERMITTING**

These plans are conditionally approved in accordance with any construction notes on plans. The building permit is license whenever any code requirements with related codes and does not constitute approval of construction. Field inspectors from originating jurisdiction to inspect codes within codes. Violations are noted during inspection.

Structural: [Signature]  
 Date: 12/7/07  
 PROPOSED STARBUCKS COFFEE

