

EXISTING INTERIOR SEATING COUNT	
DINING	
TOTAL OCCUPANCY	27
EXTERIOR SEATING COUNT	
SQ. FOOTAGE	358 sq.ft.
DINING	
TOTAL	16
at 15 sq. ft. per person complies with code	

1  
A1.01  
OCCUPANCY CALCULATIONS  
N.T.S.

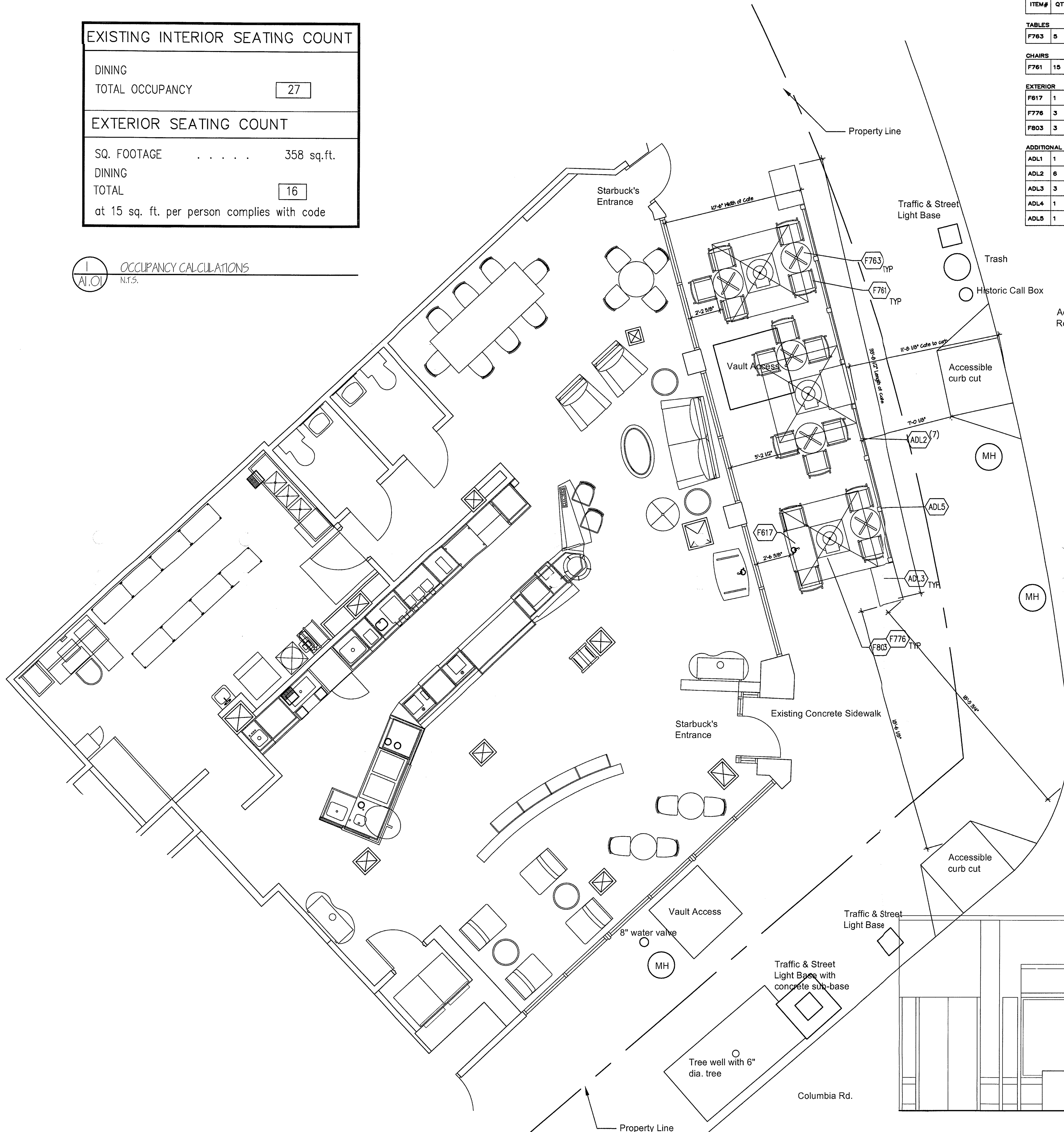

FURNITURE SCHEDULE:

ITEM #	QTY	DESCRIPTION	MANUFACTURER	MODEL #	REMARKS	SKU #	SHIP
<b>TABLES</b>							
F763	5	TABLE, PATIO ROUND METAL TOP	SMITH AND HAWKEN	896688		223250	JPL
<b>CHAIRS</b>							
F761	15	CHAIR, PATIO METAL/WOVEN	SMITH AND HAWKEN	896654		223229	JPL
<b>EXTERIOR</b>							
F617	1	TABLE ADA TEXT OUTDOOR BRONZE	WEST COAST INDUSTRIES	3131 2339 BZ	ADA COMPLIANT W/ TEXT	187111	JPL
F776	3	BASE UMBRELLA 6' 95 LBS	ULTIMATE UMBRELLA CO	SBUXACF95W		223127	JPL
F803	3	UMBRELLA 6' OUTDOOR LOGO	ULTIMATE UMBRELLA CO			394001	JPL
<b>ADDITIONAL ITEMS</b>							
ADL1	1	3'-0" RAILING	EF IRONWORKS	STEEL RAILING	PAINTED BLACK		GC
ADL2	6	4'-0" RAILING	EF IRONWORKS	STEEL RAILING	PAINTED BLACK		GC
ADL3	3	2'X3' PLANTER					GC
ADL4	1	2'X2' PLANTER					GC
ADL5	1	RAILING POST	EF IRONWORKS	STEEL POST PAINTED BLACK			GC

3  
A1.01  
OUTDOOR FURNITURE SCHEDULE  
N.T.S.

2  
A1.01  
EXISTING SEATING PLAN  
SCALE: 1/4" = 1'-0"

4  
A1.01  
ELEVATION OF EXTERIOR  
SCALE: 1/4" = 1'-0"

Chairs shown in elevation are representational. Not all chairs shown for clarity.

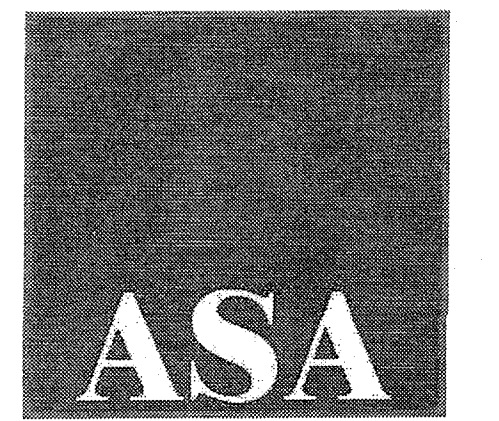

ALAN SPARBER AIA  
ARCHITECT

10712 BREWER HOUSE RD.  
N BETHESDA, MD 20852  
PH: 240.461.5017  
asparber@ASAArchitect.com



P.O. Box #141  
COLLEGE PARK, MD 20741  
PH: 410.821.9002

NOTES

PROFESSIONAL SEAL

SUBMITTALS

ITEM	DESCRIPTION	DATE

Starbucks  
Coffee Company  
#7877  
1801 Columbia Road NW  
Washington, D.C. 20009  
(202) 518-9649

SCALE: AS NOTED	MANAGER: AS	
PROJ. #:	DRAFTSMAN: ebe	A1.01
DATE: 03.23.10	SHEET: OF	