

-File
Michelle Miley
8-2010

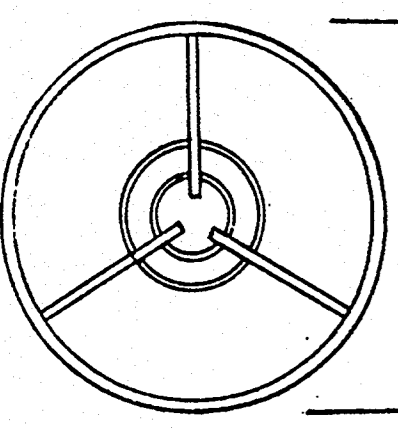

PLAN VIEW

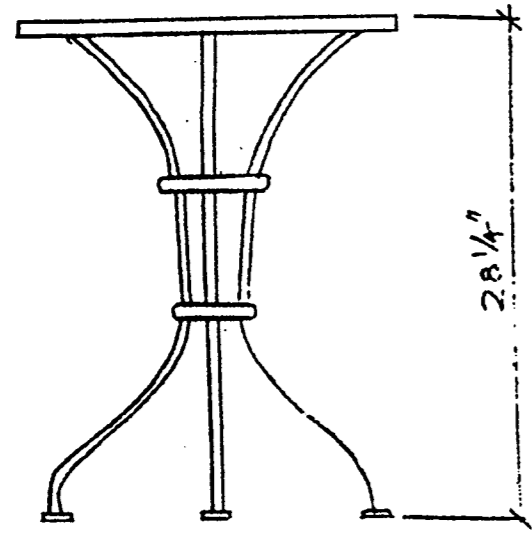

ELEVATION VIEW

1. TABLE DETAIL (WROUGHT IRON) 1"=1'-0"

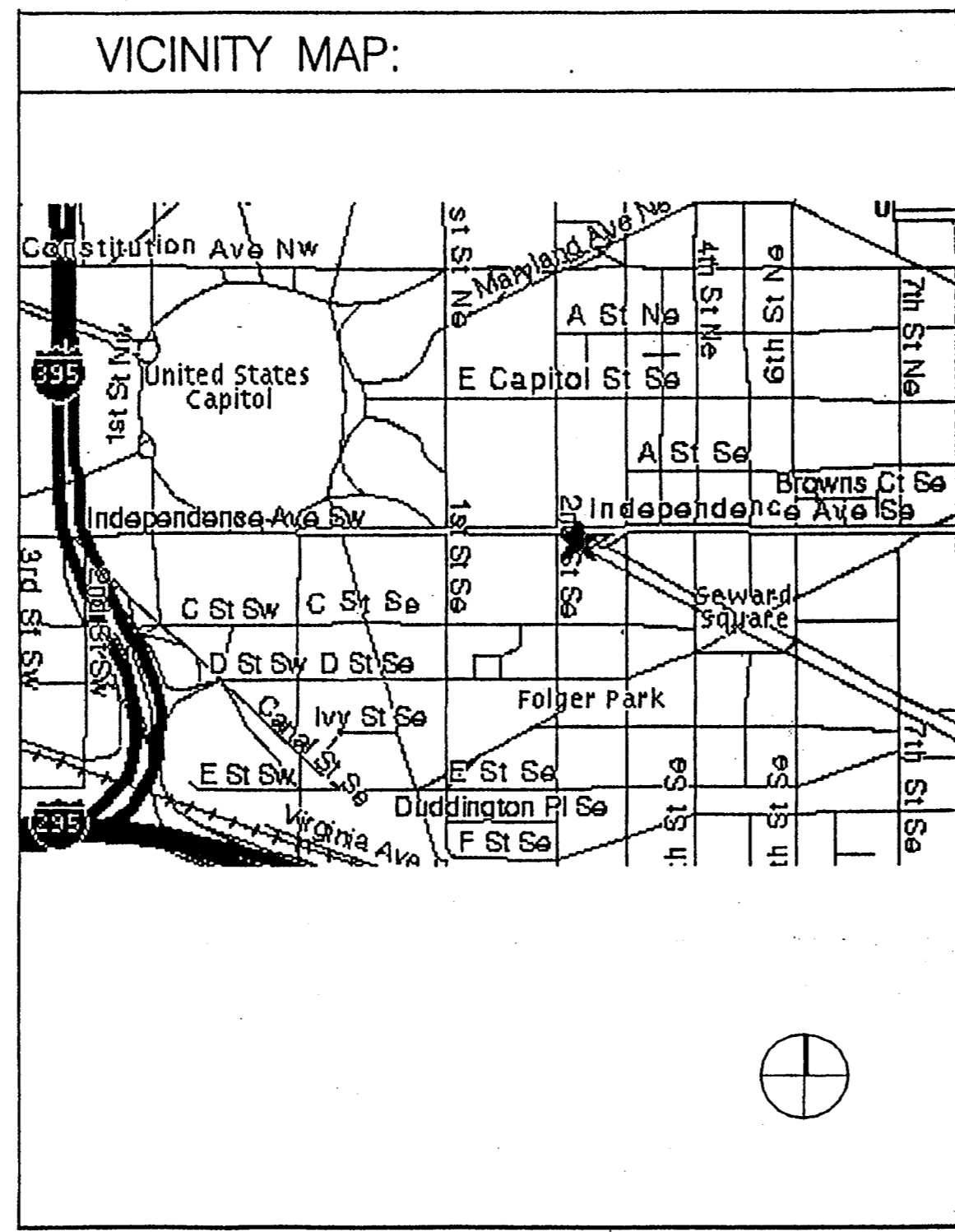

VICINITY MAP:



3rd Street, S.E. 1/8" scale



Property Line - Pennsylvania Avenue, S.E. 1/8" scale

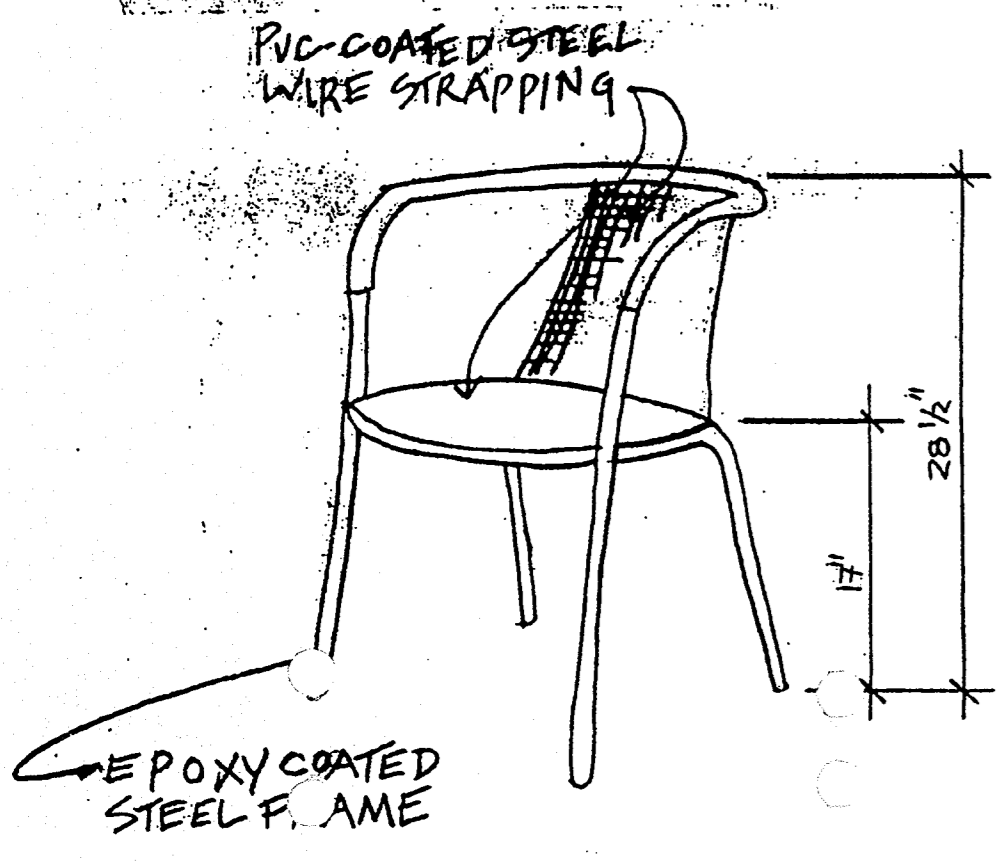

2. CHAIR DETAIL 1"=1'-0"

- Legend**
- 4 story townhouse
 - Property line
 - Starbucks Coffee existing unit
 - Trash box (2)
 - ADA handicap ramp (2)
 - Cafe seating unenclosed 3rd Street side = 352 sq. ft; Pennsylvania Avenue side = 0 sq. ft; Total retable space 352 sq. ft.
 - PEPCO metal grates (4)
 - PEPCO manhole cover (3)
 - Public works sewer cover (2)
 - Fire Hydrant
 - Pay Phone (2)
 - Gas Meter (2)
 - Existing curbs
 - Metal stacking chairs - see detail #2
 - Metal tables - see detail #1
 - Umbrellas - see detail #3
 - Property Line
 - Outside Seating Occupancy Load-15

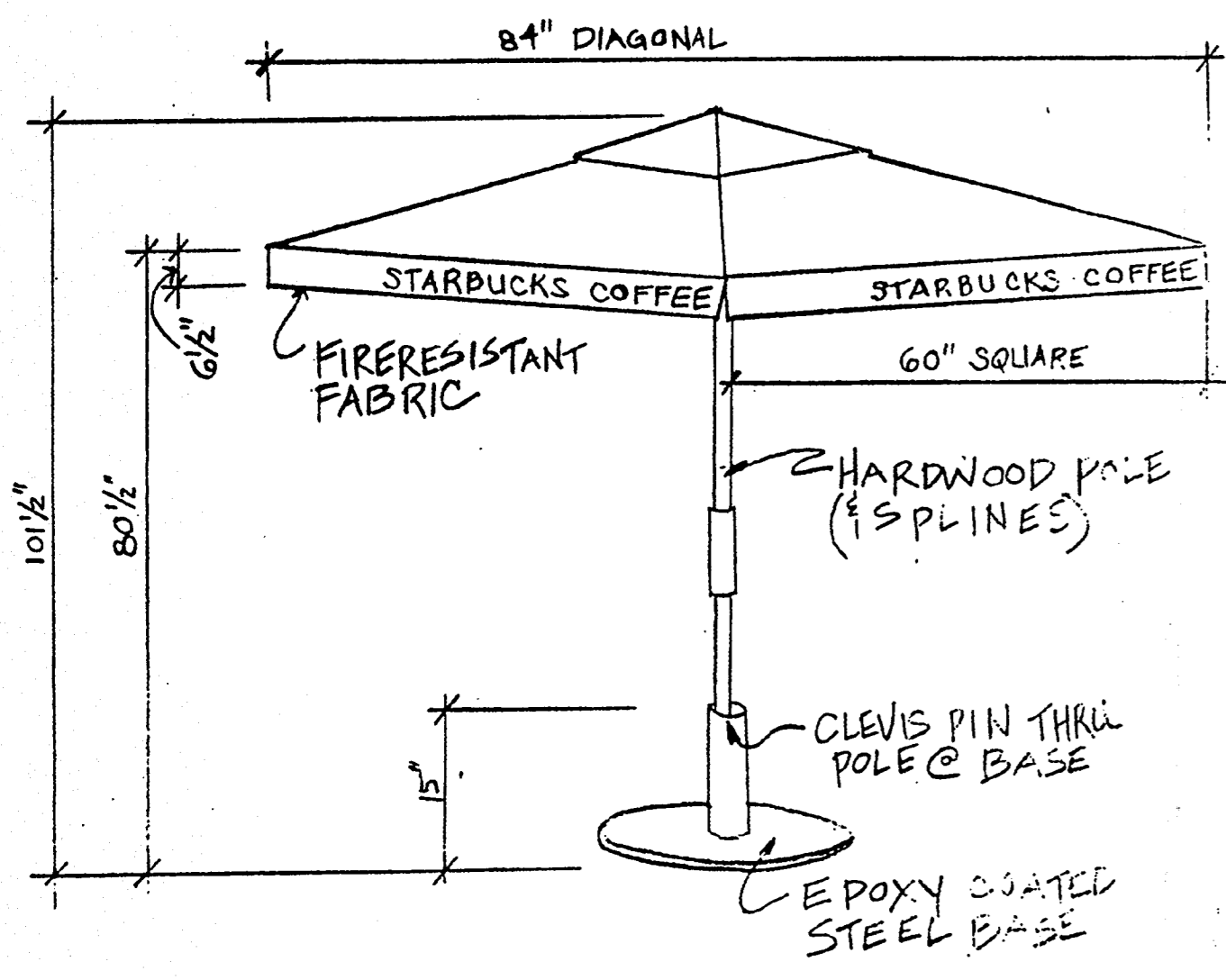

3. UMBRELLA DETAIL 1/2"=1'-0"

UPDATED SHEET: 97SEPT

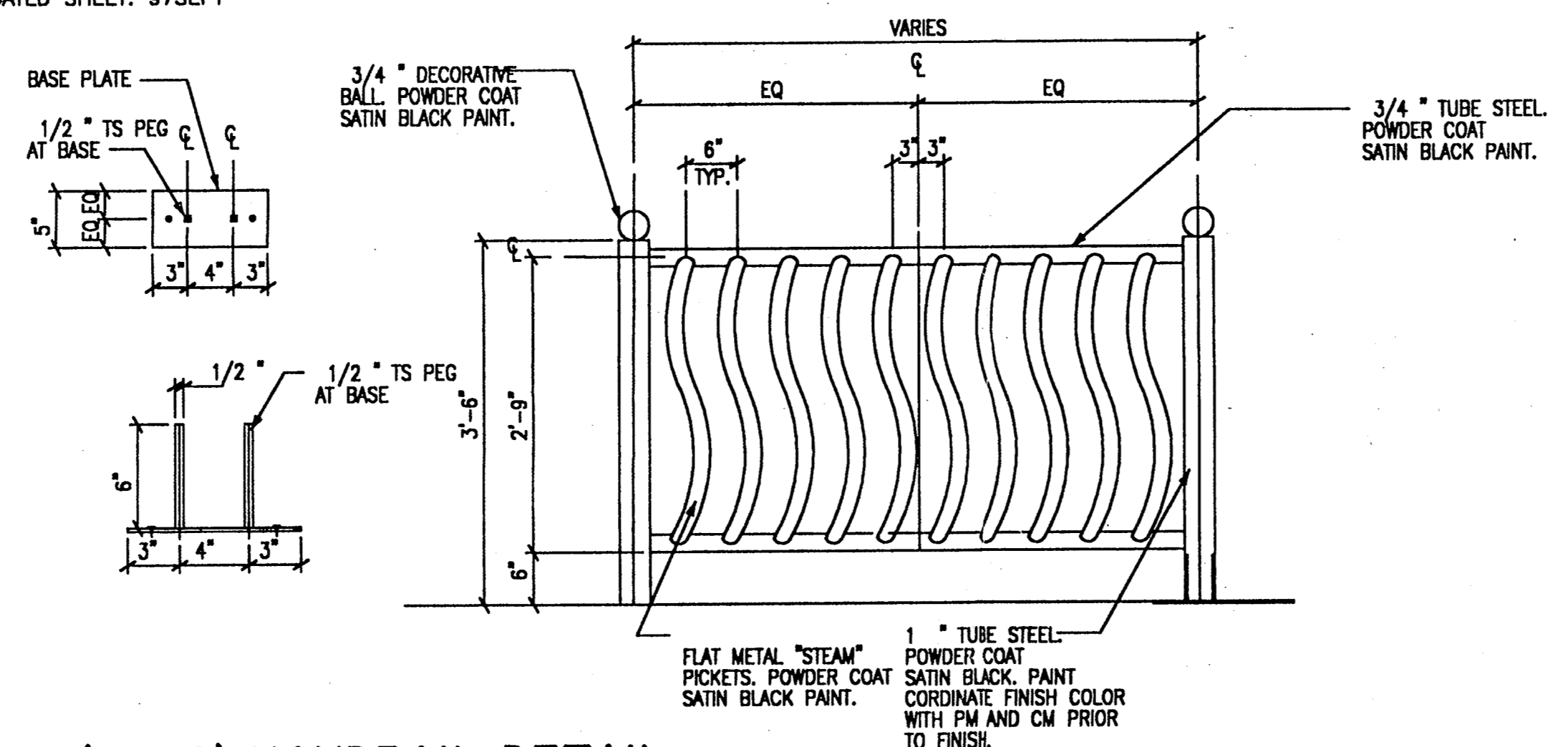

4. (ADL2) HANDRAIL DETAIL N.T.S.

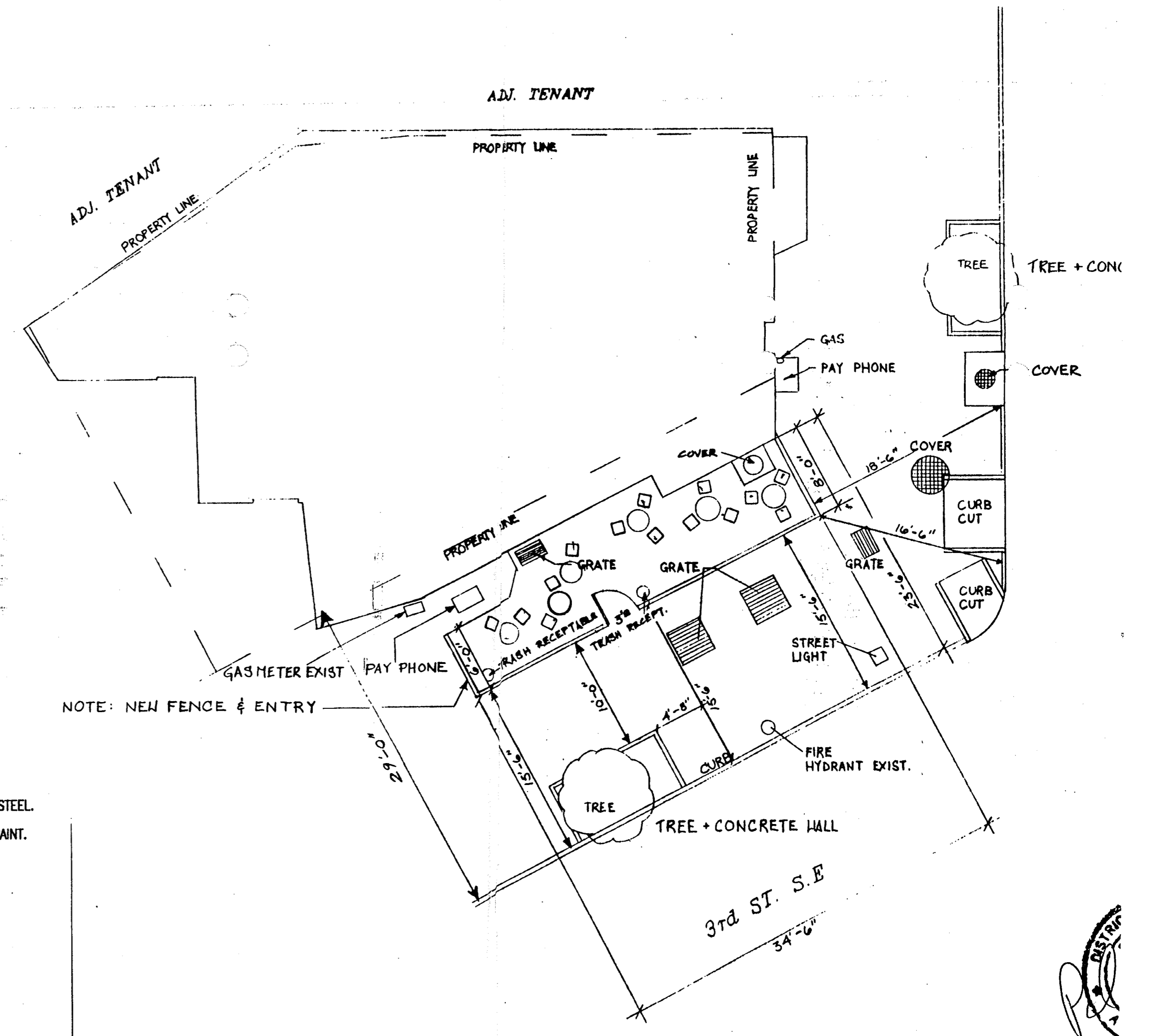

NOTE: NEW FENCE & ENTRY

DGRA
BIRL/HISTORIC PRESERVATION DIVISION
HISTORIC PRESERVATION CLEARANCE: REPAIR/IN-KIND
REPLACEMENT ONLY. NOT SUBJECT TO D.C. LAW 2-144.
WORK WILL NOT ALTER EXTERIOR APPEARANCE,
RAFTERSHIP OR MATERIALS.
HPD: *A. Carter* 10-03-09
(SIGNATURE/DATE)



PGA Design - Build
4963 Elm Street, #103
Bethesda, Maryland 20814
Ph. (301)657-3020
Fax (301)657-3050

Starbucks
237 Pennsylvania
Washington